



Los Angeles Convention Center

## Covered Areas – Exception for 2010 Auto Show Trial Use of Melting Point Product

June 25, 2010

An exception to the policy at the Los Angeles Convention Center concerning "Covered Areas" has been created on a trial bases. This exception is only approved for the 2010 LA Auto Show and will be evaluated for future consideration.

2010 LA Auto Show exhibitors in West Hall, South Hall and Kentia Hall will be allowed to cover up to 3,000 square feet "per area" without the use of a fire sprinkler system provided that all of the conditions listed below are met. Exhibitors in Concourse and Petree halls will be allowed to cover up to 1,500 square feet "per area" as long as all of the conditions listed below are met. Covered areas not meeting all of the following conditions are subject to the existing covered area policy as stated in the attached document entitled "**Information Regarding Covered Areas**". Exhibitors are urged to carefully read the attached covered area document for important information including how "areas" are defined.

1. Material/fabric shall be the "Melting Point" product that was recently tested by LAFD. No other product or model is approved for covered areas exceeding 750 square feet unless an approved fire sprinkler system is installed. Contact Paradise/GES for exact product specifications.
2. The fabric must be installed by the Paradise/GES rigging team.
3. Fabric shall be installed with adequate tension to yield maximum opening of the fabric if heat should be applied.
4. Fabric shall be supported at the ends perpendicular to the seams by use of grommets, etc. that are located midway between each seam to yield maximum opening.
5. Covered areas created by use the approved Melting Point product that do not exceed 1,500 square feet shall be separated from all other covered areas by at least 10 feet (horizontally) in all directions. Covered areas created by use of the approved Melting Point product that are over 1,500 square feet, and do not exceed 3,000 square feet, shall be separated from all other covered areas by at least 15 feet (horizontally) in all directions. Note: Concourse and Petree halls are limited to 1,500 square feet.
6. There shall be at least one smoke detector for every 1,000 square feet of covered area. Covered areas that change in elevation and thereby create sections (pockets) for smoke to gather shall have a smoke detector located near the top of each section.
7. A covered area drawing as defined in item-6 on page-5 of the **Information Regarding Covered Areas** document must be submitted for each project meeting the criteria stated in the document. Covered areas employing the use of the approved Melting Point product shall be clearly identified on the drawing so there is no confusion regarding other covered elements/materials and the Melting Point material.

All other requirements in the covered area policy apply.

Note: Fire sprinkler systems are NOT allowed in Concourse hall, Petree hall, and in LACC meeting rooms. As such, projects in said spaces must be designed in a manner that does not require the use of a fire sprinkler system.

Thomas Fields  
Building Superintendent  
Show Operations  
Los Angeles Convention Center  
1201 S. Figueroa Street  
Los Angeles, Calif. 90015  
(213) 741-1151 ext.5609  
Main Fax: (213) 765-4267  
E-mail: [tfields@lacclink.com](mailto:tfields@lacclink.com)

**For questions and/or more information, please contact:  
Thomas Fields, Building Superintendent - Show Operations  
Phone: (213) 741-1151, Ext. 5609, Fax: (213) 765-4267, E-mail: [tfields@lacclink.com](mailto:tfields@lacclink.com)**



Los Angeles Convention Center

## Information Regarding Covered Areas

Effective January 1, 2010

Booths and displays containing structures, canopies, lighting truss, or suspended items that are covered with fabric or solid materials exceeding an accumulated total of 750 sq. ft. may require the installation of an Automatic Fire Sprinkler System (AFSS). The following information will assist you in determining whether or not you require an AFSS, and ways to design around it.

### Defining "Covered"

The term "covered" is defined as any item consisting of covered elements in which the material used for creating the covering has cross sectional openings of less than  $\frac{1}{4}$  inch in two dimensions, and/or a construction that results in less than 50% of the material being open.

Materials/components that are considered covered include; standard scrim, sharks-tooth, smoke-out, deck structures, stairs, acoustic ceilings, etc. These common components are considered covered because the cross sectional opening of the material is less than  $\frac{1}{4}$  inch.

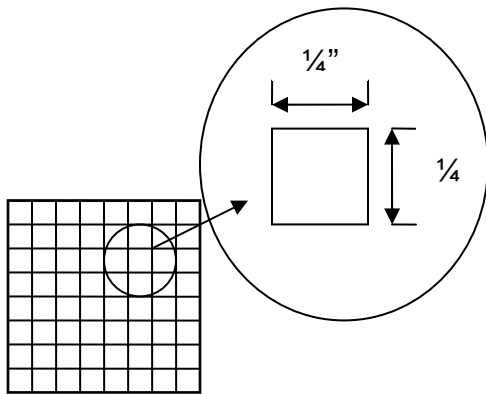

*The unobstructed openings in the material must be at least  $\frac{1}{4}$  inch in two directions.*

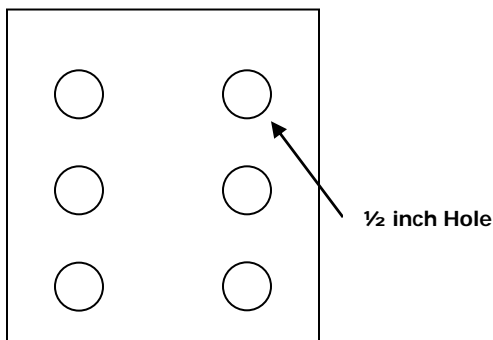

*This is an example of steel plating with  $\frac{1}{2}$  inch holes. Even though the openings are greater than  $\frac{1}{4}$  inch, this material is considered "covered" due to the majority of the material being covered (less than 50% is open).*

### **Defining “Covered Area”**

A “Covered Area” is defined as any area containing covered elements that are separated (horizontally) by less than 10 feet. A 50’ x 50’ booth space that has several covered structures throughout the booth that are all closer than 10 feet (horizontally) would be considered one (1) covered area. However, a 50’ x 50’ booth space that has four (4) 100 sq. ft. covered structures that are all separated by 10 feet or more would have four separate covered areas within the one booth space.

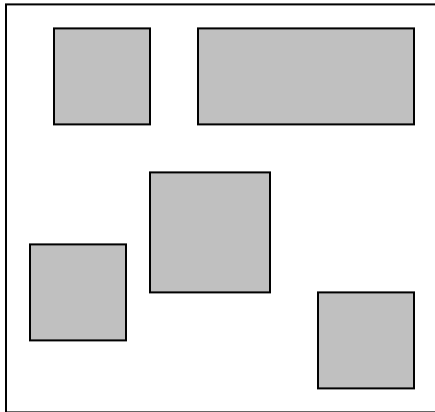

#### **One (1) Covered Area**

*Covered structures with less than 10 feet of separation.*

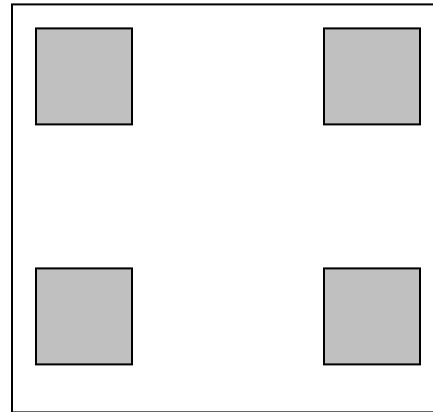

#### **Four (4) Covered Areas**

*Covered structures with 10 feet or more separation.*

### **Allowable Coverage**

The maximum amount of covering allowed in any one “area” is 750 sq. ft. Any area (as described above) that contains covered elements exceeding 750 sq. ft must be protected with an approved Automatic Fire Sprinkler System (AFSS). No other type of protection is allowed for areas exceeding 750 sq. ft. AFSS’s must be installed by a California licensed Fire Sprinkler Contractor. In addition to the installation of an AFSS, the strategic placement of fire extinguishers and smoke detectors are required as well. Placement will be determined by the Fire Inspector after reviewing design plans. Areas that have overlapping covered elements are not considered when calculating the amount of square footage in a covered area. Calculations are based on a “plan-view perspective” only.

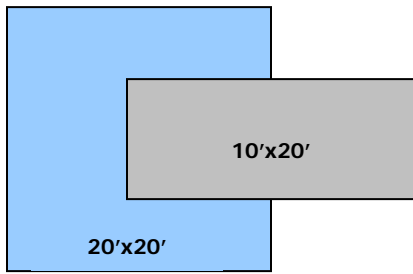

The amount of covered area in this example is 500 sqft based upon a "Plan-View Perspective". Although the two elements total 600 sqft, the overlapping portion is not considered in the covered area calculations.

**Design**

The key to avoiding an AFSS in large exhibits is to design the booth in such a manner to create multiple "covered areas" by maintaining at least 10 feet of uncovered separation between covered elements of the booth. In a large booth, having four covered structures of 750 sq. ft. is permissible without the need to install an AFSS as long as the covered areas are separated (on all sides) by at least 10 feet.

Creating one covered area that is 1,000 sq. ft. and three others that are 750 sq. ft. or less would result in the need to install an AFSS in the 1,000 sq. ft. area only (the other three would not require one).

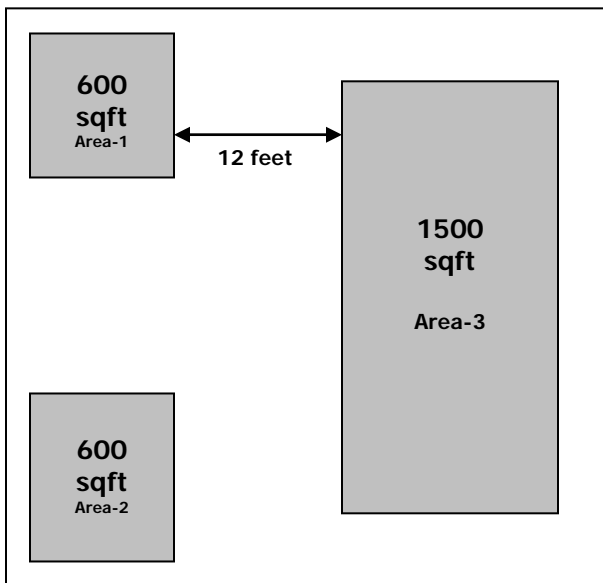

Area 3 requires an AFSS because it is over 750 sqft. However, areas 1 & 2 do not require AFSS's because they are separated by at least 10 feet.

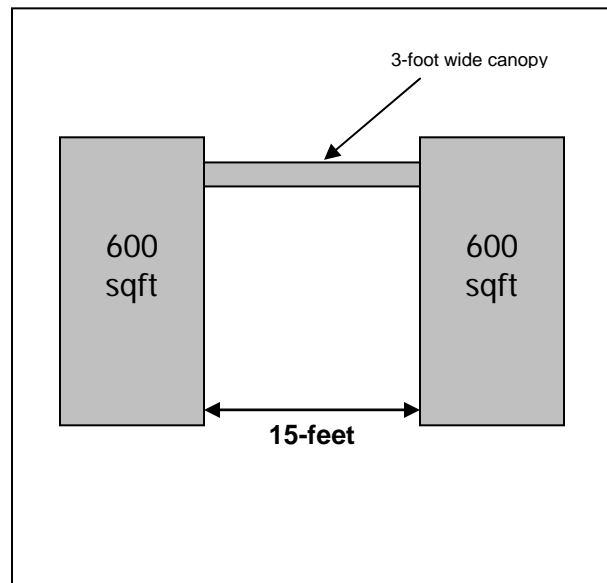

The addition of the canopy results in having one large covered area. The two 600 sqft structures and the canopy must be protected by an AFSS.

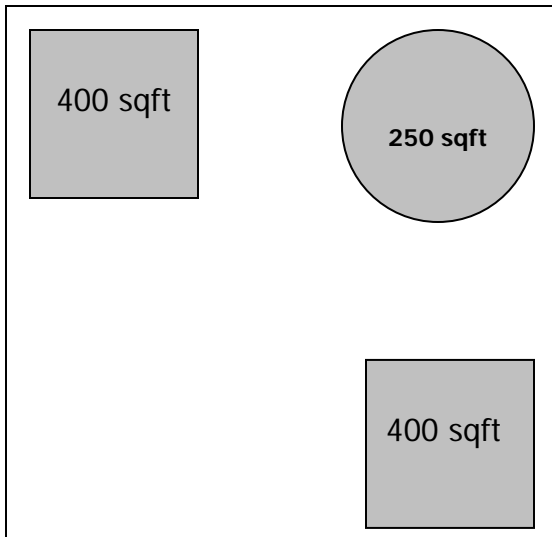

*Three separate covered areas containing less than 750 sqft each. NO AFSS required.*

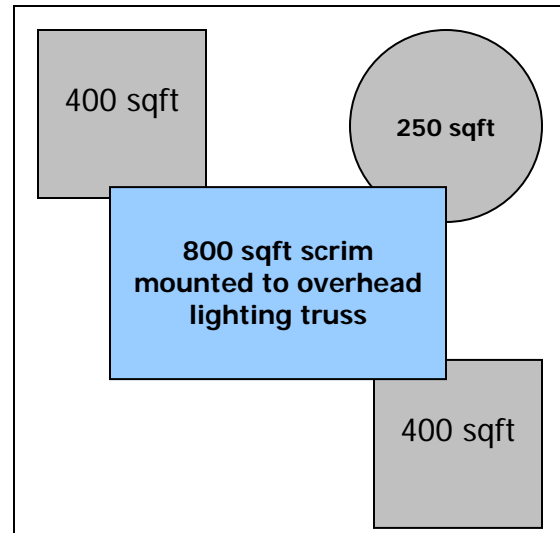

*The addition of the lighting scrim results in the entire booth being classified as one covered area (exceeding 750 sqft). ALL covered elements must be protected by an AFSS.*

### **Other things to consider**

1. Neighboring booths must be considered when planning on covered elements within 10 feet of the neighboring exhibit. If the neighboring exhibit has a covered structure that is within 10 feet of your structure, then the aggregate total is used to determine the amount of "covered area".
2. The total amount of covered area that is allowed in any exhibit hall, or public space cannot exceed 10% of the size of the room as it is configured via the use of air walls. For example, Petree Hall is 21,500 sq. ft. (when Halls C&D are combined). The maximum amount of ALL cover areas within Petree Hall added together cannot exceed 2,150 sq. ft. (10%). Approvals to build covered areas are given based on the order in which requests containing "complete information" are received. Delaying the submittal of covered area plans may result in the denial to build said covered area.

3. Under certain circumstances LACC meeting rooms located on the second level of the Convention Center can be covered up to the lesser of the following two parameters: 70% of the total area of the meeting room, OR, 750 sq. ft. A 24-hour Fire Watch must be established once the covered area has been constructed, until the time it is removed. Show Security personnel shall be used for fire watch duties. There must be a designated officer in the room at all times. A telephone must be installed within the respective meeting room for immediate use by the fire watch officer. In addition, an LAFD Fire Inspector must be hired to patrol all of the meeting room spaces and corridors that contain covered areas during the non-show hours of the event. Payment of Fire Inspector should be handled through Show Management.
4. Sprinkler systems can only be installed in the South, West, and Kentia halls. Installing sprinkler systems in Concourse Hall, Petree Hall, all meeting rooms and public spaces is not allowed. Therefore, projects must be planned in these areas so that no covered area exceeds 750 sq. ft., and that the covered area is in compliance with the 10% (70% in LACC meeting rooms) requirement mentioned above.
5. All fabrics and materials must be certified as "Flame Proof" or "Flame Retardant" by the California State Fire Marshall. Flame proof certificates must be kept in the booth for Fire Inspector review. Flame proofing certificates from other states (or countries) will not be accepted. Material believed to be acceptable but not having a California certificate can be sent to the LAFD Fire Inspector for testing. Test samples should be 12"x12" in size and should be mailed with any other pertinent information to the Fire Inspector at the address listed below.
6. Booths containing more than 400 sq. ft. of covered elements are required to submit drawings to the Fire Inspector and the LACC Building Superintendent / Show Operations at the address listed below. Send two (2) plan view drawings of the booth indicating (by shading in) the areas/elements that are covered and the calculated square footage of each covered area. Also include the respective dimensions (in feet & inches) of the structures/elements and the separation between them. In addition send perspective/isometric drawings to better define the project. Drawings may also be e-mailed in a PDF or JPEG format. Plans must be submitted for ANY proposed covered area in LACC meeting rooms. Plans must show the entire meeting room and the square footage thereof, and the respective design and square footage of the proposed covered elements.

7. Non-combustible stages and platforms that do not exceed 5 feet in height “may” be exempt from the 750 sq. ft. limitation provided that no combustible materials or sources of heat are placed under the stage/platform. Projects involving stages/platforms not exceeding 5 feet in height require a covered area drawing to be submitted as indicated above. The covered area plan should denote the height of the platform and use a different shading pattern to distinguish the platform from the other covered elements in the booth.
8. LACC fire sprinkler systems shall not be impeded or obstructed. A clearance of 36 inches must be maintained from all LACC sprinkler heads.
9. Battery operated smoke detectors must be installed as an early warning device in any covered area that exceeds 100 sq. ft.
10. Stairs, ramps, vehicles and/or equipment are considered “covered” and therefore must be included in the covered area calculations.
11. For information on licensed Fire Sprinkler Contractors that have worked in the facility, contact the Building Superintendent / Show Operations.

For further information, clarification or discussion, please contact:

Tom Fields  
Building Superintendent  
Show Operations  
Los Angeles Convention Center  
1201 S. Figueroa St.  
Los Angeles, CA 90015  
(213) 741-1151 Ext. 5609  
Fax: (213) 765-4267  
Email: [Tfields@lacclink.com](mailto:Tfields@lacclink.com)

Clinton Pruiet  
Fire Inspector  
Public Assembly  
Los Angeles Convention Center  
1201 S. Figueroa St.  
Los Angeles, CA 90015  
(213) 741-1151 Ext. 5370  
Fax: (213) 765-4266  
Email: [Cpruiet@lacclink.com](mailto:Cpruiet@lacclink.com)